

The Community Partnerships and Grants Program (CPG)

The Community Partnerships and Grants (CPG) Program is King County Parks' public-private partnership initiative whereby community-based organizations are empowered to design, develop, construct, operate, program, and/or maintain new and enhanced public recreation facilities on King County Parks land. King County Parks can provide the CPG partner with a capital grant up to \$100,000, as well as establishing long-term use agreements up to 40 years. Some CPG projects have also received grants from the Youth Sports Facilities Grants program or large grants from the capital budget. The community-based partner contributes additional capital resources from their private fundraising efforts, in-kind donations of goods and services, and "sweat equity," a.k.a. their volunteer labor.

The CPG Program has 3 goals:

1. Develop new and enhanced recreation facilities without increasing tax-funded operations and maintenance costs.
2. Empower community-based organizations to invest in their communities and leverage investments of cash, in-kind donations, and sweat equity into the King County Parks system.
3. Develop a network of community-based organizations whose success is interdependent with the success of King County Parks.

Established in 2003, the CPG Program has been the catalyst for 40 projects that have been completed or are currently in development. When completed, these projects will add public recreation facilities values at an estimated \$50 million.



New Boathouse at Marymoor Park

CPG Partner: Sammamish Rowing Association

Project Value: \$3,675,000 in design and construction, plus all maintenance and programming

SRA Contribution: \$3,000,000+ in capital and in-kind plus all programming, operations, and maintenance for 30 years

King County Contribution: \$675,000 (CPG, YSFG, and CIP)

Status: Under construction **Completion:** Fall 2012



New Community Center at Lakewood Park

CPG Partner: Technology Access Foundation (TAF)

Project Value: \$12,000,000 in design and construction, plus all maintenance and programming

TAF Contribution: \$10,000,000+ in capital and in-kind plus all programming, operations, and maintenance for 40 years

King County contribution: \$2,000,000 (CIP)

Status: Under construction **Completion:** Fall 2012



Preston Athletic Fields and Community Park

CPG Partner: Preston Park, LLC (Eastside FC), Issaquah Little League, and Preston Community Club

Project Value: \$6,225,000 in planning, design, and construction, plus all maintenance and programming

PPLC Contribution: \$3,000,000+ in capital and in-kind plus \$1,200,000 towards maintenance for 10 years

King County contribution: \$3,225,000 (CPG, YSFG, CIP)

Completed: 2008 (Phase 1) and 2011 (Phase 2)



New 100 acre Mountain Bike Park at Duthie Hill

CPG Partner: Evergreen Mountain Bike Alliance

Project Value: \$1,300,000

EMBA Contribution: \$1,000,000 in design, engineering, capital, in-kind, and volunteer labor, plus maintenance

King County contribution: \$300,000 (CPG and YSFG)

Completion: Fall 2012



New Synthetic Sportsfields at Ravensdale Park

CPG Partner: Ravensdale Park Foundation

Project Value: \$1,900,000

RPF Contribution: \$400,000+ in capital and in-kind plus supplemental maintenance

King County contribution: \$1,400,000 (CIP)

Completed: March 2012 (Phase 1), Phase 2 design development underway



New Synthetic Lacrosse Facility at Big Finn Hill

CPG Partner: Kirkland Lacrosse

Project Value: \$1,800,000

KYL Contribution: \$1,800,000

King County contribution: \$0

Completion: Fall 2012



New Synthetic Soccer Complex at Petrovitsky

CPG Partner: Kent Youth Soccer Association

Project Value: \$2,150,000

KYSA Contribution: \$1,800,000 in capital and in-kind contributions

King County contribution: \$350,000 (CPG)

Completion: April 2012



Community Park @ White Center Hights
w/ White Center CDA



Whitewater Access @ Tanner Landing
w/ American Whitewater



RC Flying Facility @ Hobart
w/ Lake Sawyer Hawks

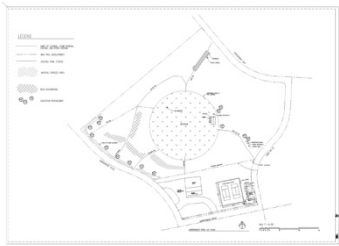

New Park @ Mirrmont
w/ Mirrmont Community Assoc.



New Baseball Fields at Houghton
w/ Kirkland American LL



Audubon Interpretive Center
w/ Washington Audubon

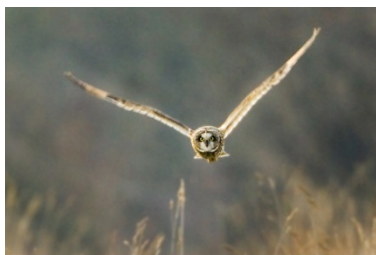

Birdloop Trail @ Marymoor
w/ Eastside Audubon



Velodome Race Building / Track
w/ Marymoor Velodrome Assoc.



Baseball Improvements @ Big Finn
w/ Kirkland National LL



Equestrian Facility Redevelopment
w/ Hollywood Hills Saddle Club



New Community Garden
w/ Mirrmont Community Assoc.

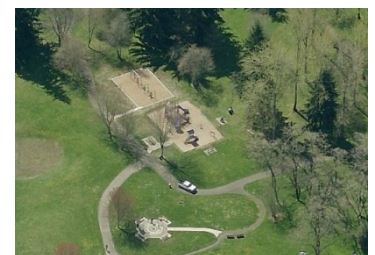

New Playground @ 132nd Park
w/ Totem Lake Neighborhood Assoc.



Equestrian Facilities @ Island Center
w/ Vashon Forest Stewards

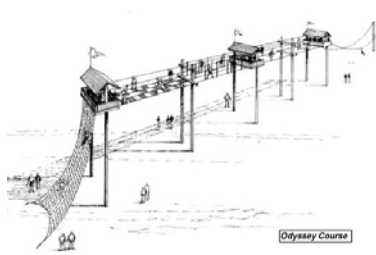

Challenge Course @ Cottage Lake
w/ YMCA Seattle



New Synthetic Baseball Stadium
w/ White Center CDA



Maury Island Marine Park
w/ Friends of Maury Island Marine Park



Interpretive Center / Trails @ Dockton
w/ Friends of Dockton Park



May Valley Heights Redevelopment
w/ Maple Valley Heights Community



New Tennis Courts @ Steve Cox Park
w/ CDBG & Kennedy High School



N. Green River Park Redevelopment
w/ Kent Youth Soccer Association



Habenicht Park Redevelopment
w/ Maple Valley Rotary Club



Junction Plaza Park Redevelopment
w/ Seattle Parks Foundation



Beaver Lake Restoration Project
w/ Mid Green River Coalition



Beaver Project @ Cemetery Pond
w/ C.A.R.E.



Dodd Fields Synthetic Redevelopment
w/ Issaquah Little League

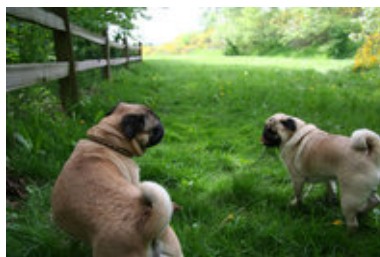

Dog Park @ Grandview
w/ SODA South



Improvements @ 60 Acres
w/ Lake Washington Youth Soccer



Community Meadow @ Ravensdale
w/ Ravensdale Park Foundation



Regional Volunteer Program
w/ Friends of Cedar River Watershed



CPG Mini Grants Program
25 Grants from 2011 to 2013