

SEC'S 18, 19, 20, 29 TWP. 25 N., RGE. 06 E, W.M.

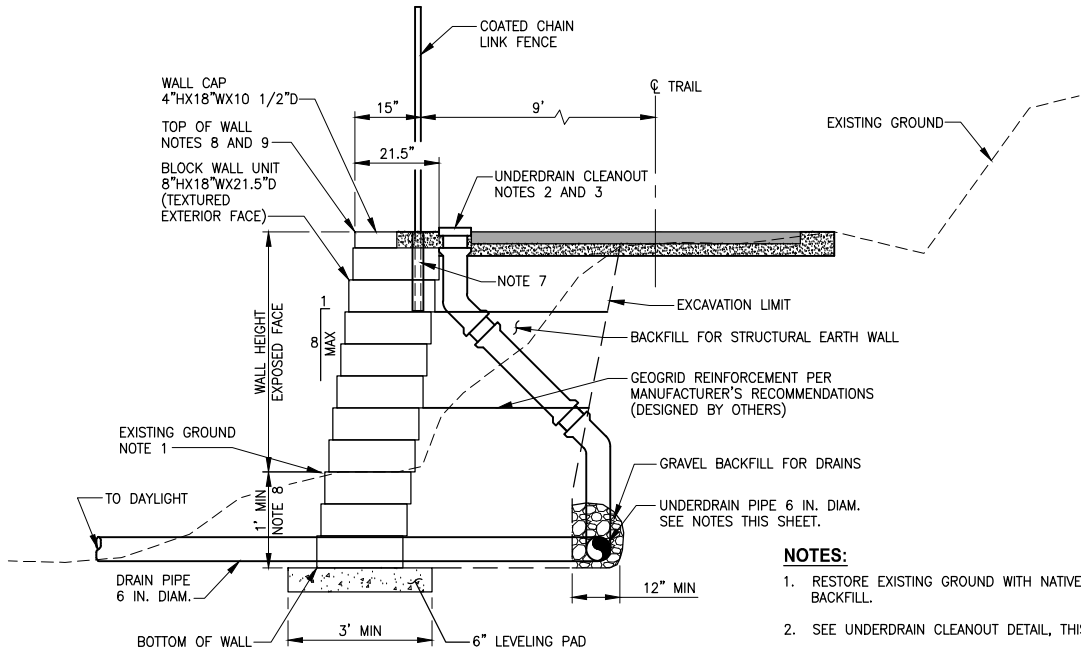

STRUCTURAL EARTH WALL (FOR FILL WALL)
DETAIL
NO SCALE

NOTES:

1. RESTORE EXISTING GROUND WITH NATIVE SOIL BACKFILL.
2. SEE UNDERDRAIN CLEANOUT DETAIL, THIS SHEET.
3. UNDERDRAIN CLEANOUT LIDS SHALL NOT BE LOCATED IN TRAIL HMA PAVEMENT.
4. UNDERDRAINS SHALL BE SLOPED TO DRAIN.
5. UNDERDRAIN SHALL BE WRAPPED IN CONSTRUCTION GEOTEXTILE FOR UNDERGROUND DRAINAGE.
6. FILL BLOCK UNITS WITH UNIT DRAINAGE FILL. SEE SPECIAL PROVISIONS FOR WALL DESIGN REQUIREMENTS. ALL CONSTRUCTION MUST CONFORM TO MANUFACTURER'S SPECIFIC REQUIREMENTS.
7. POST SHALL HAVE MIN 24" DEPTH. SEE DETAIL 4 THIS SHEET.
8. SEE WP SHEETS FOR TOP AND BOTTOM OF WALL ELEVATIONS.
9. SEE WALL SCHEDULE FOR TOP OF WALL STATION AND OFFSET.

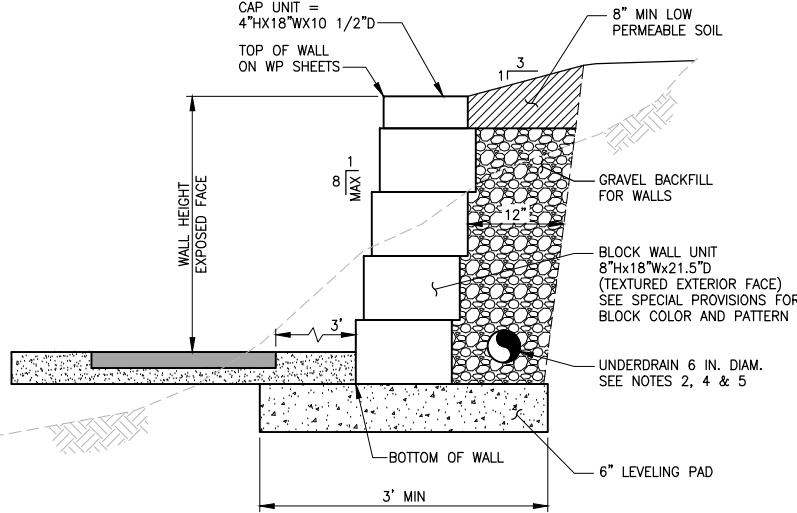

MODULAR BLOCK WALL - CUT WALL
DETAIL
NO SCALE

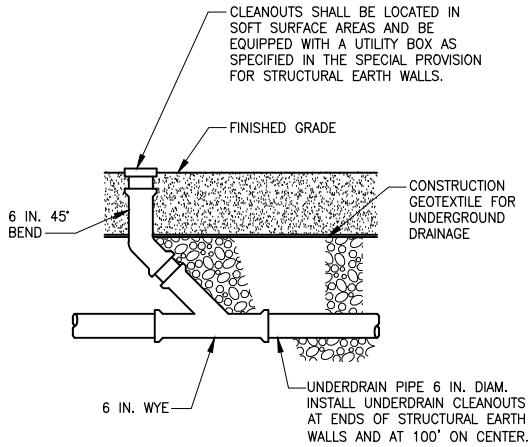

UNDERDRAIN CLEANOUT
DETAIL
NO SCALE

WALL SCHEDULE

| WALL # | ALIGNMENT | BEGIN STA | END STA | OFFSET | SIDE | EXPOSED WALL HEIGHT RANGE | FILL/CUT | NOTE |
|----------|-----------|-----------|-----------|------------|------|---------------------------|----------|-----------------------|
| WALL 1 | A-LINE | 476+00.50 | 476+09.50 | 11.0' | LT | 2.0' - 4.0' | FILL | STRUCTURAL EARTH WALL |
| WALL 1A | A-LINE | 476+09.50 | 476+09.50 | 17.0' | LT | 2.5' - 3.0' | FILL | STRUCTURAL EARTH WALL |
| WALL 2 | A-LINE | 479+50.00 | 479+03.50 | 17.0' | LT | 4.0' - 4.5' | FILL | STRUCTURAL EARTH WALL |
| WALL 2A | A-LINE | 479+03.50 | 480+02.00 | 11.0' | LT | 2.0' - 4.0' | FILL | STRUCTURAL EARTH WALL |
| WALL 3 | A-LINE | 483+76.50 | 484+81.50 | 11.0/9.0' | RT | 4.0' - 6.0' | CUT | STRUCTURAL EARTH WALL |
| WALL 4 | A-LINE | 484+50.00 | 487+00.50 | 11.0' | LT | 2.0' - 5.5' | FILL | STRUCTURAL EARTH WALL |
| WALL 5 | A-LINE | 492+06.62 | 493+00.00 | 22.0/18.5' | LT | 0.5' - 5.0' | FILL | STRUCTURAL EARTH WALL |
| WALL 6 | A-LINE | 493+29.00 | 501+00.00 | 11.0' | LT | 2.5' - 7.5' | FILL | STRUCTURAL EARTH WALL |
| WALL 6A | A-LINE | 503+19.46 | 503+02.47 | 9.9' | LT | 0.5' - 5.0' | FILL | STRUCTURAL EARTH WALL |
| WALL 6B | A-LINE | 503+20.97 | 503+55.45 | 10.0' | RT | 0.5' - 4.5' | FILL | STRUCTURAL EARTH WALL |
| WALL 7 | A-LINE | 504+35.00 | 505+49.00 | 11.0' | LT | 0.5' - 2.0' | FILL | STRUCTURAL EARTH WALL |
| WALL 8 | A-LINE | 508+20.00 | 509+55.00 | 9.0' | RT | 1.0' - 5.5' | CUT | STRUCTURAL EARTH WALL |
| WALL 9 | A-LINE | 509+50.00 | 510+65.50 | 11.0' | LT | 0.5' - 3.5' | FILL | STRUCTURAL EARTH WALL |
| WALL 10 | A-LINE | 510+48.43 | 510+03.43 | 11.0' | RT | 0.5' - 3.0' | FILL | STRUCTURAL EARTH WALL |
| WALL 11 | A-LINE | 511+04.00 | 511+97.00 | 9.0' | RT | 2.0' - 6.5' | CUT | STRUCTURAL EARTH WALL |
| WALL 12 | A-LINE | 512+25.00 | 514+78.09 | 9.0' | RT | 1.5' - 7.0' | CUT | STRUCTURAL EARTH WALL |
| WALL 13 | A-LINE | 516+08.00 | 517+32.50 | 11.0' | LT | 0.5' - 3.5' | FILL | STRUCTURAL EARTH WALL |
| WALL 13A | A-LINE | 517+32.50 | 518+38.33 | 15.5' | LT | 2.0' - 6.5' | FILL | STRUCTURAL EARTH WALL |
| WALL 14 | A-LINE | 519+80.00 | 520+43.00 | 11.0' | LT | 2.0' - 2.5' | FILL | STRUCTURAL EARTH WALL |
| WALL 15 | A-LINE | 521+42.40 | 522+56.40 | 11.0' | LT | 1.0' - 5.0' | FILL | STRUCTURAL EARTH WALL |
| WALL 16 | A-LINE | 522+56.40 | 523+56.00 | 12.5' | LT | 4.0' - 9.0' | FILL | STRUCTURAL EARTH WALL |
| WALL 16A | A-LINE | 523+56.00 | 528+19.50 | 11.0' | LT | 0.5' - 6.5' | FILL | STRUCTURAL EARTH WALL |
| WALL 16B | A-LINE | 525+49.18 | 525+71.68 | 10.0' | RT | 0.5' - 3.5' | FILL | STRUCTURAL EARTH WALL |
| WALL 16C | A-LINE | 528+04.28 | 528+20.78 | 10.0' | RT | 0.5' - 2.5' | FILL | STRUCTURAL EARTH WALL |
| WALL 17 | A-LINE | 532+00.00 | 540+85.00 | 11.0' | LT | 0.5' - 7.0' | FILL | STRUCTURAL EARTH WALL |
| WALL 17A | A-LINE | 538+97.88 | 539+32.36 | 11.0' | RT | 0.5' - 5.0' | FILL | STRUCTURAL EARTH WALL |
| WALL 18 | A-LINE | 541+91.50 | 547+81.00 | 9.0' | LT | 0.5' - 6.5' | CUT | STRUCTURAL EARTH WALL |
| WALL 19 | A-LINE | 551+49.50 | 554+00.00 | 11.0' | RT | 3.0' - 7.0' | FILL | STRUCTURAL EARTH WALL |
| WALL 20 | A-LINE | 555+03.87 | 555+80.50 | 9.0' | RT | 2.0' - 4.5' | CUT | STRUCTURAL EARTH WALL |
| WALL 21 | A-LINE | 557+00.00 | 563+01.50 | 11.0' | LT | 1.5' - 6.5' | FILL | STRUCTURAL EARTH WALL |
| WALL 22 | A-LINE | 562+79.88 | 568+77.31 | 9.0' | RT | 2.5' - 8.5' | CUT | SOLDIER PILE WALL |
| WALL 23 | A-LINE | 572+79.00 | 575+65.50 | 11.0' | LT | 2.5' - 6.0' | FILL | STRUCTURAL EARTH WALL |
| WALL 24 | A-LINE | 577+40.00 | 578+75.00 | 11.0' | LT | 1.5' - 6.5' | FILL | STRUCTURAL EARTH WALL |
| WALL 25 | A-LINE | 579+49.50 | 588+33.50 | 11.0' | LT | 2.0' - 7.0' | FILL | STRUCTURAL EARTH WALL |
| WALL 26 | A-LINE | 586+33.50 | 589+23.50 | 17.0' | LT | 3.0' - 5.5' | FILL | STRUCTURAL EARTH WALL |
| WALL 27 | A-LINE | 589+23.50 | 589+40.00 | 11.0' | LT | 1.5' - 6.0' | FILL | STRUCTURAL EARTH WALL |

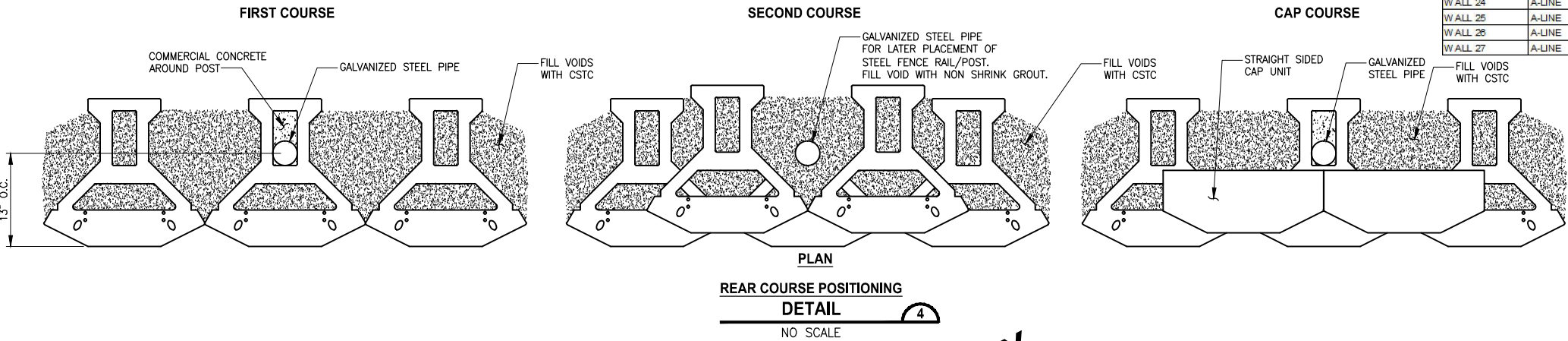

REAR COURSE POSITIONING
DETAIL
NO SCALE

90 % REVIEW SUBMITTAL
NOT FOR CONSTRUCTION

| REVISIONS | DATE | BY | DESIGNED |
|-----------|------|----|-------------|
| | | | J. JUN |
| | | | B. PURGANAN |
| | | | Y. HO |
| | | | APPROVED |

| |
|--|
| ONE INCH AT FULL SCALE. IF NOT, SCALE ACCORDINGLY |
| FILE NAME BL1521075P15T03WD-01 |
| JOB No. 554-1521-075-P15T03 |
| DATE NOVEMBER 2012 |



| | |
|--|---|
| Parametrix | ENGINEERING · PLANNING · ENVIRONMENTAL SCIENCES |
| 411 106TH AVENUE N.E., SUITE 1800 BELLEVUE, WASHINGTON 98004 T. 425.458.6200 F. 425.458.6363 www.parametrix.com | |

| | |
|--------------|--|
| PROJECT NAME | EAST LAKE SAMMAMISH MASTER PLAN TRAIL NORTH SAMMAMISH SEGMENT SAMMAMISH, WA |
|--------------|--|

| |
|---|
| STRUCTURAL EARTH WALL DETAILS AND SCHEDULE |
|---|

| |
|------------------------|
| SHEET NO. 93 OF 114 |
| WD1 |